



**Data Logger with
Optional Thermal Shield
Part of the NOMAD® Family**



OM-CP-HITEMP150,
shown larger
than actual size.

OM-CP-HITEMP150 data logger, shown
inside optional OM-CP-HITEMP150-TS thermal
shield, shown larger than actual size

OM-CP-HITEMP150



Optional

- ✓ **Operating Temperature Range: -40 to 150°C (-40 to 302°F)**
- ✓ **Optional Thermal Shield for Operation up to 250°C (482°F)**
- ✓ **Submersible to 70 m (230')**
- ✓ **Programmable Start Time**
- ✓ **User Calibration Through Software**
- ✓ **Real-Time Operation**
- ✓ **Autoclave Verification**
- ✓ **Pharmaceutical**
- ✓ **Implement HACCP Programs**
- ✓ **Food Preparation and Processing**

- ✓ **Environmental Studies**
- ✓ **Well Monitoring**
- ✓ **Dish Washer Testing**
- ✓ **Hostile Environment Monitoring**

The OM-CP-HITEMP150 submersible temperature data logger is a battery-powered, stand-alone device that can record up to 32,767 temperatures ranging from -40 to 150°C (-40 to 302°F). It's 51 mm (2") long rigid external probe lets the user take quick, accurate measurements.

The OM-CP-HITEMP150 is ideal for harsh environments. Its real-time clock ensures that all data is time and date stamped. The storage medium is non-volatile solid state memory, providing maximum data security even if the battery becomes discharged.

The OM-CP-HITEMP150 can be started and stopped directly from your computer, and its small size allows it to fit almost anywhere. Data retrieval is simple. Plug it into an empty USB or COM port and the Windows software does the rest.

The software converts a PC into a real-time strip chart recorder. Data can be printed in graphic or tabular format and can be exported to a text or Microsoft Excel file.

Specifications GENERAL

Temperature Sensor: 100 Ω Platinum RTD

Temperature Range: -40 to 150°C (-40 to 302°F)

Temperature Resolution: 0.05°C
Calibrated Accuracy: ±0.5°C

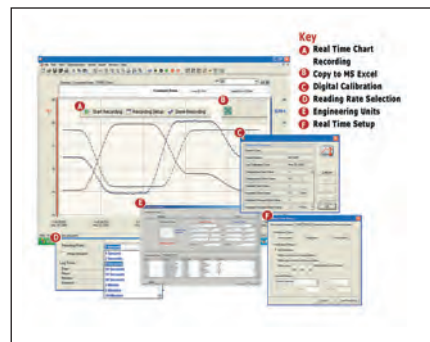

OM-CP-IFC200, Windows software displays data in graphical or tabular format.



Start/Time: Software programmable start time and date, up to 6 months in advance

Real-Time Recording: Device may be used with PC to monitor and record data in real time

Memory: 32,767 readings

Reading Interval: 1 reading every 2 seconds to 1 every 12 hours, selectable through software

Calibration: Digital calibration is available through software

Calibration Date: Automatically recorded within device

Power: 3.9 V lithium battery (included), factory replaceable only

Battery Life: 1 year typical (1 minute reading rate @ 25°C)

Time Accuracy: ±1 minute per month at 20°C (RS-232 cable not in use)

Computer Interface: PC USB or serial (interface cable required); 2400

Software: XP SP3/Vista and 7 (32-bit and 64-bit)

Operating Environment: -40 to 150°C (-40 to 302°F); 0 to 100% RH, non-condensing

Data Format: Date and time stamped, °C, °F, K, °Ra

Weight: 225 g (8 oz)

Computer Interface: PC serial, RS-232C COM or USB

Dimensions (Body):

28 H x 45 mm Dia.
(1.1 x 1.75")

Dimensions (Probe):

51 L x 5 mm Dia.
(2.0 x 3/16")

Construction: 316 SS
(food grade)

Specifications (Thermal Shield)

Operating Environment: -200 to 250°C (-328 to 482°F)
time limited, 0 to 100% RH

IP Rating: IP68

Dimensions: 53.3 H x 66 mm
dia (2.1 X 2.6")

Weight: 0.3kg (0.65lb)

Material: Teflon (food grade)



OM-CP-HITEMP150-TSK data logger, shown larger than actual size. Includes OM-CP-HITEMP150, data logger in optional OM-CP-HITEMP150-TS thermal shield,

Operating Temperatures When Enclosed in Optional Thermal Shield

Ambient Temperature	Time in Air to Max Internal Temp (150°C/302°F)	Time in Liquid to Max Internal Temp (150°C/302°F)
160°C (320°F)	75 min	34 min
170°C (338°F)	63 min	29 min
180°C (356°F)	55 min	26 min
190°C (374°F)	50 min	23 min
200°C (392°F)	45 min	21 min
210°C (410°F)	42 min	19 min
220°C (428°F)	39 min	18 min
230°C (446°F)	36 min	17 min
240°C (464°F)	34 min	16 min
250°C (482°F)	32 min	15 min

AVAILABLE FOR FAST DELIVERY!

To Order (Specify Model Number)		
Model No.	Price	Description
OM-CP-HITEMP150		Extended-range submersible temperature data logger
OM-CP-HITEMP150-CERT		Extended-range submersible temperature data logger and NIST calibration certificate
OM-CP-HITEMP150-TSK		OM-CP-HITEMP150 data logger with thermal shield
OM-CP-HITEMP150-TSK-CERT		OM-CP-HITEMP150 data logger with thermal shield and NIST calibration certificate
OM-CP-HITEMP150-TS		Thermal shield for OM-CP-HITEMP150 data logger
OM-CP-IFC200		Windows software and 3.7 m (12') USB interface cable

Comes complete with 3.6V lithium battery. Operator's manual and interface cable are included with the OM-CP-IFC200 software/cable package (required for data logger operation, sold separately).

Ordering Example: OM-CP-HITEMP150-TSK, data logger with thermal shield and OM-CP-IFC200, Windows software and 1.2 m (4') USB interface cable,