

SIM CARD

The SIM card receptacle is intended for 3V SIM cards [GSM 11.12 phase 2+]. The SIM card must be inserted in the cardholder to put the unit into operation.

Make sure that there is no voltage applied to GsmControl+. Disconnect also the backup battery, if any. Following the figure below:

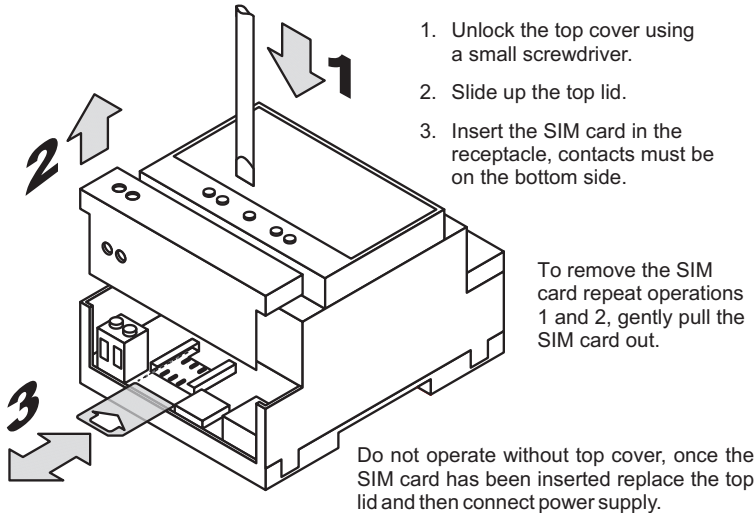

ACCESS INSIDE

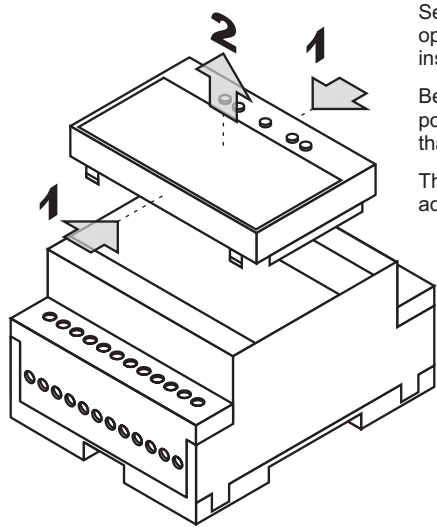

Serial communication port and optional backup battery are located inside the unit.

Before opening the unit disconnect power supply and all live circuits that may be connected.

The front cover must be removed to access the inside of the unit :

1. Push with two fingers on top and bottom sides of front cover to release it.
2. Pull the front cover and keep it in a safe place.

The newer NiMH batteries are less harmful to the environment, have a longer life, and contain recyclable materials. Recycling options available in your local area should be considered when disposing of this product. Do not dispose of in fire.

BACKUP BATTERY

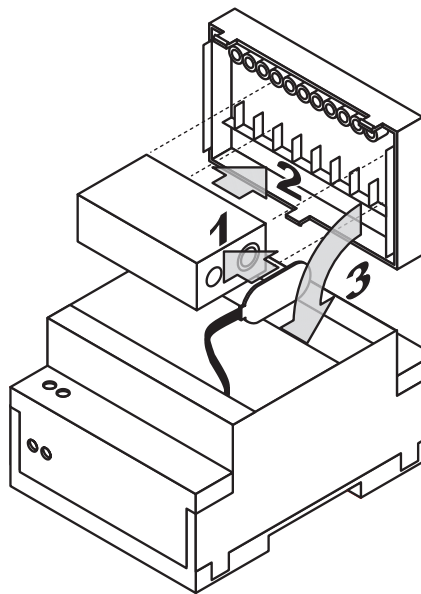

If the unit is provided with UPS feature, a backup battery can be installed to keep the device working even during power failures. Once the front cover has been removed:

1. Clip the battery to available connector. This connector must be isolated when operating without backup battery.
2. Push the battery into retainer lids located under front cover.
3. Replace the front cover to close the unit.

WHEN USING BATTERIES AND ACCUMULATORS ADHERE TO RELEVANT REGULATIONS

Use only NiMH rechargeable batteries 8.4V or 9.6V type.

COM PORT

ADVANCED CONFIGURATION, LOCAL CONTROL, TRACING AND OTHER FEATURES ARE AVAILABLE THROUGH SERIAL COMMUNICATION LINK

Specific literature and software **GsmSuite** for PC running Microsoft® Windows® are available for free download at www.gsm-control.biz.

Remove the front cover following the instructions to access the RJ45 8 pin modular jack serial interface [P].

Link cable **1013.00.02** is available from local resellers.

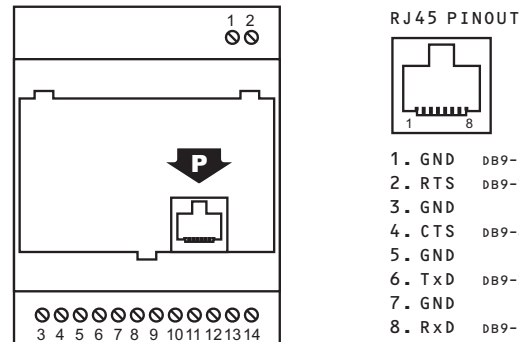

Communication: RS-232 (DCE)
300 ... 115200 bit/s
7/8 data bits, 1/2 stop bits, 1 parity bit, 10/11 bit char length
Software handshake, Hardware handshake

SIM PIN

Operating without SIM PIN

The simplest way is to put your SIM card into a cellular phone and program it so it won't ask for the PIN. The SIM card is 'open' and someone could steal the SIM card, use it and read the information inside.

Enter default SIM PIN

GsmControl+ comes with a default PIN = **0000** (four zeroes).

Put your SIM card into a cellular phone and program the PIN using the given number.

Change default SIM PIN

Using com port and **GsmSuite** running on Microsoft® Windows® PC you can modify the default PIN on both GsmControl+ and SIM card.

WARNING

If you insert a SIM card that asks for a PIN number different from that stored into GsmControl+, the device will not operate. If you enter the PIN 3 times incorrectly, SIM card will lock up and you must provide the PUK (PIN Unblocking Key).

DEVICE INFO

To identify your device more easily, you can store some specific information.

A supervisor can issue the following SMS:

+3,300,tel,info,,,,email,text

tel	Device own phone number	20 CHAR MAX	[1]
info	Short description	14 CHAR MAX	
email	Optional device own email address	40 CHAR MAX	[2]
text	Detailed device application info	56 CHAR MAX	

Example: +3,300,+4456789,Building 1,,,,Apt. 5 living room

info and text will be shown within status SMS sent by this unit.

[1] Device phone number (always in international format) will be used to perform real time clock autosync, missing this field the real time clock is unreliable and SMS commands involving date field will be rejected.

[2] All email issued from Gprs type unit will be sent carbon copy also to its own mailbox if a valid address is provided.

STATUS SMS

Following a typical status SMS issued on request:

Building 1	Short description
door control unit	Detailed device application info
Out1:off	output released
Out2: on 00:01:22	remaining time to output off
In 1 :3.14 V	measured voltage (analog mode input)
In 2 :open	input open
Clip:pulse on	clip mode and status
Blackout	Main power failure detected

Out 1 / 2 status: off output inactive
on output active, remaining time to disable could follow
!on output active and latched
| reverse or pulse clip sequence in progress

In 1 / 2 status: open input open, inactive
close input close, active

FREE CLIP CONTROL

Registered users can control outputs by means of simple (free) calls. Supervisors can set different activation times and outputs behaviour issuing an SMS:

+2,290,,pulse,rev1,hold,rev2,answ,mode

pulse	On time	01 - 60" default 3"
rev1	Out1 ON time in reverse mode	01 - 60" default 3"
hold	Hold time in reverse mode	01 - 600" default 3"
rev2	Out2 ON time in reverse mode	01 - 60" default 3"
answ	Time to answer in toggle mode	01 - 60" default 15"
mode	none, pulse, toggle, reverse, dtmf	

NONE

Clip feature is disabled, nothing happens on incoming calls from registered users.

PULSE (default)

Selecting this mode, incoming voice (or fax) call from registered user will turn on out 1 for the time set in pulse. A data call will do the same on out 2.

TOGGLE

Incoming voice (or fax) calls will toggle out 1 on to off or vice-versa, data calls will do the same on out 2. A ringback will be issued only when an output is turned on. If the user waits online, after the time specified in answ GsmControl+ will answer, playing a low tone after output release or four high tones after output activation. No ringback will be issued in such case.

REVERSE

This mode involves both outputs. Any incoming call from registered users will start a sequence: out 1 will be activated for the time specified in rev1, after the delay set in hold, out 2 will be activated for the time specified in rev2.

DTMF

GsmControl+ will answer to incoming call from registered users that, after a short welcome tone, can type the command code on the phone keyboard. Following default commands can be changed to any custom one using **GsmSuite**.

1	2	3
OUT1 ON	OUT2 ON	-
4	5	6
OUT1 OFF	OUT2 OFF	-
7	8	9
OUT1 LATCH	OUT2 LATCH	-
*	0	#
CONFIRM	STATUS	DELETE

Once all commands are issued, confirm the execution typing * (star) key. Using # (hash) key is possible to delete everything and start from the beginning.

Correct commands will be confirmed by four short high tones. Wrong commands will produce a long low tone.

SYSTEM COMMANDS

Special control SMS are reserved for supervisors only:

Stop

Disable free calls control feature (CLIP): incoming calls will be rejected.

Start

Enable free calls control feature (CLIP): incoming calls from registered users will activate outputs following the specified sequence.

Lista#

An SMS reporting last # (1-9) answered call list will be sent. Full list specifying 0.

Listu#

An SMS reporting last # (1-9) unanswered call list will be sent. 0 = full list.

Pbook

An Email reporting the complete phonebook will be issued to supervisor's email address, if any (GPRS only).

Pbook++

An Email reporting the complete phonebook and all system settings will be issued to supervisor's email address, if any (GPRS only).

ADVANCED CONFIGURATION

Using GsmSuite is possible to configure advanced features, either linking the unit with local com port or issuing SMS in remote mode. Refer to GsmSuite help file or Advanced Manual for detailed information. Most important advanced features:

Add / edit Recipients (group 9)

Alerts following local events can be issued to Recipients (up to 100).

Add / edit Supervisors (group 7)

Up to 100 supervisors can be stored inside the unit.

Add / edit Users (group 0 / group 1)

Users can be stored into SIM card phonebook.

Conditional users (having more features) can be stored into device memory.

Delete Phonebook entries

Remove any entry from phonebooks by means of GsmSuite or issuing an SMS.

GPRS / Email settings

Emails service configuration, available for GPRS devices.

Scheduled operations

Activities to be performed on a time basis (up to 100).

THE INFORMATION CONTAINED IN THIS DOCUMENT ARE SUBJECT TO CHANGE WITHOUT NOTICE. PRODUCT NAMES, CORPORATE NAMES OR TITLES USED WITHIN THIS DOCUMENT MAY BE TRADEMARKS OR REGISTERED TRADEMARKS OF OTHER COMPANIES AND ARE MENTIONED ONLY IN AN EXPLANATORY MANNER TO THE READERS' BENEFIT, AND WITHOUT INTENTION TO INFRINGE.

WHILE EVERY EFFORT HAS BEEN MADE TO MAKE SURE THE INFORMATION IN THIS DOCUMENT IS CORRECT, CONTRIVE CAN NOT BE LIABLE FOR ANY DAMAGES WHATSOEVER FOR LOSS RELATING TO THIS DOCUMENT.

WARRANTIES

CONTRIVE GUARANTEES FOR TWO YEARS FROM THE DATE OF MANUFACTURE OF ITS PRODUCT TO REPLACE, OR, AT ITS OPTION, TO REPAIR ANY PRODUCT OR PART THEREOF WHICH IS FOUND DEFECTIVE IN MATERIAL OR WORKMANSHIP OR WHICH OTHERWISE FAILS TO CONFORM TO THE DESCRIPTION OF ITS SALES ORDER. CONTRIVE MAKES NO WARRANTY OF MERCHANTABILITY OR ANY OTHER WARRANTY EXPRESS OR IMPLIED. IN NO EVENT SHALL CONTRIVE BE LIABLE FOR CONSEQUENTIAL OR SPECIAL DAMAGES OF ANY NATURE WHICH MAY ARISE IN CONNECTION WITH SUCH PRODUCTS.

THE WARRANTY DOES NOT APPLY IN CASE OF IMPROPER USE

QUICK START

Add Users (group 0)

Remote control is allowed to registered users only.

It's possible to add, modify or delete subscribers from the SIM card phonebook using any GSM mobile phone or SIM card reader/writer.

Following operating instructions provided by phone manufacturer insert the SIM card into the SIM card holder, turn on the phone and scroll the option menu to enter the SIM card Phonebook edit mode.

Enter the users name and telephone number using international format.

Insert the SIM card into the device SIM card holder and turn on the power supply, the unit is ready to operate.



Store first supervisor

Although it is not mandatory to store a supervisor, you may add a supervisor who then has additional special commands only available to him (advanced manual). To store the first supervisor, once the unit is operative, issue the following SMS:

```
#xxxx.Name.email*
# start character
xxxx system PIN (default = 0000) 4 CHARACTERS
Name supervisor's name to be stored 14 CHARACTERS MAX
email optional email address 40 CHARACTERS MAX
* end character
```

Example: #0000.Harry Potter.harry.potter@hogwarts.com*

The telephone number of SMS sender is automatically collected from the incoming call presentation (thus the telephone number must be kept visible) and will be assumed as the first supervisor's telephone number. First supervisor will be stored at position 401 and the unit will send back a confirmation or error SMS.

Dots are allowed ONLY within the email address field.

It's possible to use both ? and @ characters before the domain name.

i SMS delivery failure is usually less than 1% but you must keep in mind that a message could not arrive and you cannot complain with your operator for this. **GsmControl+ deletes any pending SMS at power-on.**