

# Quick Guide

QG\_ITAG3\_150327\_EN\_CN REV. A

## TempSen® ITAG®3 Series Temperature Recording Labels

### 1> Overview

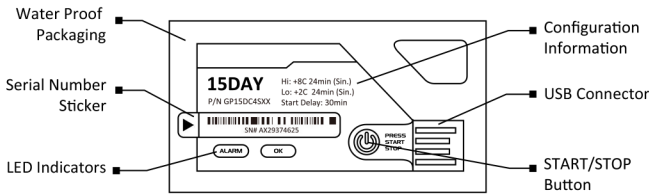

### 2> Operation Instructions

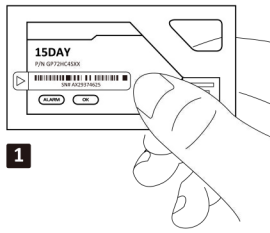

#### Start Recording

Press button and hold for 5 seconds to start. LEDs flash in turn for 3 times indicating data logger successfully starts recording.

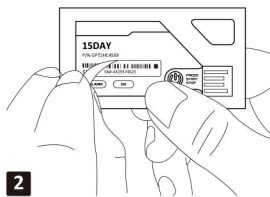

#### Serial Number Sticker

Take off the serial number sticker for the record purpose.

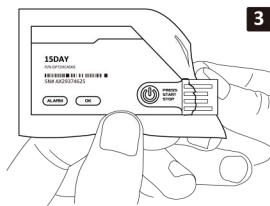

#### Stop Recording

Press button and hold for 5 seconds to manually stop recording, then tear open package to expose the USB plug. Logger also would stop recording after running out preset logging cycle.

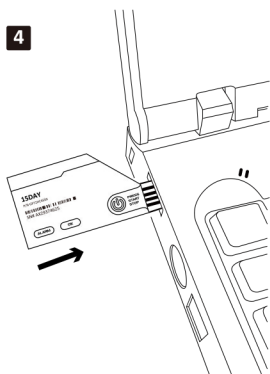

#### Download Data

Plug ITAG3 data logger into USB port of PC.

- You could download data from **ITAG3 Pro** by copying PDF data report from removable storage device **TempSenDisk**.
- You also could download ITAG3 and ITAG3 Pro logger using TempCentre software.

Please download TempCentre from [www.tempsen.com](http://www.tempsen.com)

### 3> Battery

Battery Expiry Date (EXP Date) is printed on the rear side of each logger, ITAG3 may stop recording if it's used later than EXP Date, so please check EXP Date every time starting an ITAG3 to avoid recording failure.

### 4> LED Indication

Actions	LED Sequences
Start Recording	<b>ALARM</b> & <b>OK</b> flash in turn for 3 times
During Recording -No Alarm-	<b>OK</b> flashes every 10 seconds
During Recording -Alarmed-	<b>ALARM</b> flashes every 10 seconds
Stop Recording	<b>ALARM</b> & <b>OK</b> flash for 3 times
After Stopped -No Alarm-	<b>OK</b> flashes 2 times every 2 seconds
After Stopped -Alarmed-	<b>ALARM</b> flashes 2 times every 2 seconds
Connecting to PC	<b>ALARM</b> & <b>OK</b> become solid. <b>ALARM</b> lights off 1 second after connected indicating processing data.



To avoid unnecessary loss to your goods, please do not use the data logger without LED response after started.

### 5> Important Information

a) To avoid damaging your ITAG3 data logger, please do not disconnect it from USB port while it is communicating with the computer. b) Data stored in ITAG3 data logger is retrievable even battery runs out. c) ITAG3 data logger uses CR2032 lithium battery, please do not heat, microwave or recharge it. d) Please follow local regulations when recycling or disposing of ITAG3 data loggers.

### 6> Warranty

TempSen warrants this TempSen-branded hardware product against defects in materials and workmanship under normal use for a period of ONE (1) YEAR from the date of retail purchase by the original end-user purchaser ("Warranty Period"). If a hardware defect arises and a valid claim within the Warranty Period, as its option and to the extent permitted by law, TempSen will either (1) repair the hardware defect at no charge, using new parts or parts equivalent to new in performance and reliability, (2) exchange the new product with a product that is new or equivalent to new in performance and reliability and is at least functionally equivalent to the original product, or (3) refund the purchase price of this product. TempSen may request that you replace defective parts with new or refurbished user-installable parts that TempSen provides in fulfillment of its warranty obligation. A replacement product or parts, including a user-installable part that has been installed in accordance with instructions provided by TempSen, assumes the remaining warranty of the original product or ninety (90) days from the date of replacement or repair, whichever provides longer coverage for you. When a product or part is exchanged, any replacement item becomes your property and the replaced item becomes TempSen's property. Parts provided by TempSen in fulfillment of its warranty obligation must be used in products for which warranty service is claimed. When a refund is given, the product for which the refund is provided must be returned to TempSen and becomes TempSen's property.

#### EXCLUSIONS AND LIMITATIONS

This Limited Warranty applies only to the hardware product manufactured by or for TempSen that can be identified by the "TempSen" trademark, trade name, or logo affixed to it. The Limited Warranty does not apply to any non-TempSen hardware product or any software, even if packaged or sold with the TempSen hardware. Manufacturers, suppliers, publishers, other than TempSen, may provide their own warranties to the end user purchaser, but TempSen, in so far as permitted by law, provides their products "as is". Software distributed by TempSen with or without the TempSen brand name (including, but not limited to system software) is not covered under this Limited Warranty. Refer to the licensing agreement accompanying the software for details of your rights with respect to its use.

TempSen does not warrant that the operation of product will be uninterrupted or error-free. TempSen is not responsible for the damage arising from failure to follow instructions relating to the product's use.

This warranty does not apply: (a) to consumable parts, such as batteries, unless damage has occurred due to a defect in materials or workmanship; (b) to cosmetic damage, including but not limited to scratches, dents, and broken plastic on ports; (c) to damage caused with non-TempSen products; (d) to damage caused by accident, abuse, misuse, flood, fire, earthquake, or other external causes; (e) to damage caused by operating the product outside the permitted or intended uses described by TempSen; (f) to damage caused by service (including upgrades and expansions) performed by anyone who is not a representative of TempSen or TempSen Authorized Service Provider; (g) to a product or part that has been modified to alter functionality or capability without the written permission of TempSen; or (h) if any TempSen serial number has been removed or defaced.

IMPORTANT: DO NOT OPEN THE HARDWARE PRODUCT. OPENING THE HARDWARE PRODUCT MAY CAUSE DAMAGE THAT IS NOT COVERED BY THIS WARRANTY. ONLY TEMPSEN OR AN AUTHORIZED SERVICE PROVIDER SHOULD PERFORM SERVICE ON THIS HARDWARE PRODUCT.

**TEMPSEN**